

INSTRUCTION MANUAL

for

CLAYCO SPORTS

MODEL—AKS

SEMI-AUTOMATIC

RIFLE



A COPY OF THE INSTRUCTION MANUAL FOR EACH MODEL CLAYCO SPORTS FIREARM IS AVAILABLE FROM THE IMPORTER ON REQUEST. THESE INSTRUCTION MANUALS CONTAIN IMPORTANT WARNINGS WHICH SHOULD BE UNDERSTOOD BEFORE USING THESE FIREARMS. THIS INSTRUCTION MANUAL SHOULD ALWAYS ACCOMPANY THIS FIREARM AND BE TRANSFERRED WITH IT UPON CHANGE OF OWNERSHIP.

CLAYCO SPORTS LTD.

614 Fifth Street

Clay Center, Kansas 67432

PARTS LIST

501A	Buttstock, Standard
501B	Butt Plate (Std. Model)
501C	Butt Plate Screws (Std. Model)
501D	Butt Plate Cap (Std. Model)
501E	Butt Plate Cap Spring (Std.)
501F	Butt Plate Spring (Oiler Removal)
501G	Buttstock Sling Swivel (Std. Model)
501H	Buttstock Sling Swivel Screw (Std.)
501J	Buttstock Tang Screw (Std. Model)
502A	Receiver & Trigger Guard Compl. (Folding)
502B	Receiver & Trigger Guard Compl. (Std.)
502C	Lock Lever, Gas Cylinder
502D	Gas Connector
502E	Barrel
502F	Front Sight Ramp
502G	Buttstock, Folding
503	Action Cover
504	Grip
505	Grip Screw Washer
506	Grip Screw
507	Grip Screw Nut
508	Lower Handguard
509	Upper Hand Guard Compl.
509A	Upper Hand Guard
509B	Gas Cylinder
510	Compensator
511	Compensator Lock
512	Compensator Lock Spring
513	Compensator Lock Pin
514	Front Sight Adjusting Block
515	Front Sight Post
516	Cleaning Rod
517	Rear Sight
518	Rear Sight Spring
519	Rear Sight Adjusting Slide Assy.
519A	Rear Sight Adjusting Block
519B	Rear Sight Adjusting Slide Spring
519C	Rear Sight Adjusting Slide Insert
520	Gas Piston
521	Gas Piston Retaining Pin
522	Bolt Carrier
523	Bolt

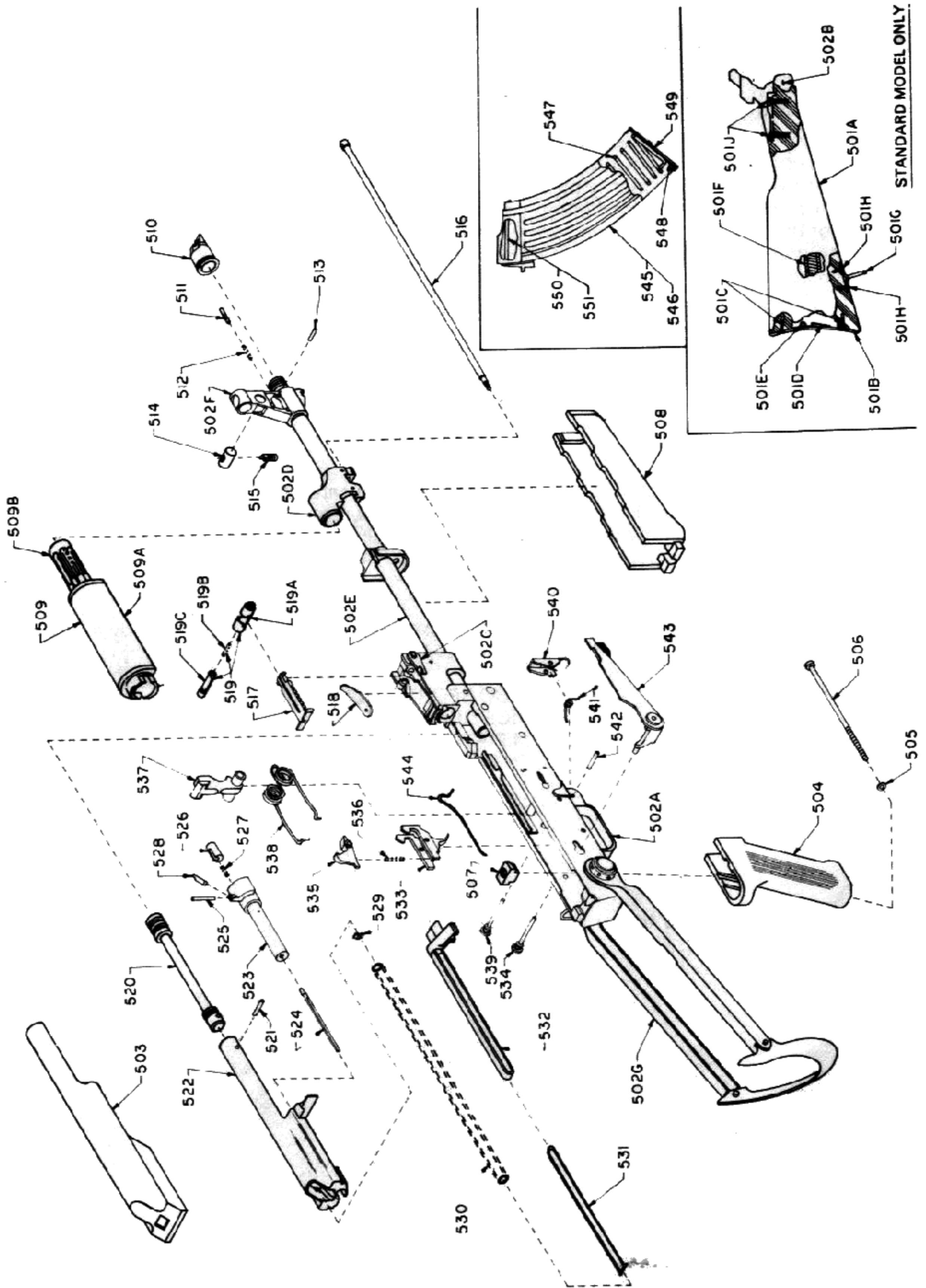

STANDARD MODEL ONLY

REASSEMBLY

Reassembly is just the reverse of steps for disassembly. The compensator is replaced by turning it on the muzzle counter-clockwise and is retained by the compensator lock. The upper handguard with gas cylinder is replaced and locked. Next, assemble the bolt by replacing the extractor, extractor spring and extractor retainer pin. Now, place the firing pin into the bolt and retain it with the firing pin retaining the pin. Next, replace the bolt into the bolt carrier assembly. The bolt carrier with gas piston is next inserted into the rear of the gas cylinder. After insertion, the bolt carrier with bolt, is depressed into the receiver rails and smartly pushed forward by the bolt operating handle. The action return spring is now inserted into the rear of the bolt carrier and securely locked into the rear of the receiver. The action cover is replaced next. The action cover must fit properly in the groove below the rear sight and be held in position by the action return spring retaining block.

SERVICE

Before shipment every CLAYCO SPORTS firearm is carefully inspected and test fired in order to prove that it is in perfect condition and conforms to our specifications and standards. If there is any question with regard to the performance of the rifle, please write to our Service Department, fully describing all circumstances and conditions involved.

If your rifle should require service or repair we suggest you return it to our own repair facility for servicing. The address is:

**CLAYCO SPORTS LTD.
SERVICE DEPARTMENT
614 FIFTH STREET
CLAY CENTER, KANSAS 67432**

Please do not send to our service center your scope or gun case with the firearm being sent for repair.